

ecology centre at lake laurentian

agamjot moti

nestled against the rock, the revamped ecology centre aims to connect sudbury's mining history to its current reforestation efforts, and bring awareness to the impacts of the city's past, and how, as a result, the landscape has transformed from barren wastelands to thriving forests. while the ecology centre aims to celebrate nature and all it has to offer, the building is grounded to express the heaviness in the rockscape of sudbury, and its importance to the mining industry today.

placing emphasis on the topography and geological history of the site, the main material for the project is rammed earth using local soils, siting the building uniquely to its location. the layered effect of the rammed earth expresses the stratum found in rocks and is composed to reflect the strata layers found in regional rocks.

using inspiration from a mining site, the act of ascent and descent is explored in the path to, and within the structure through a series of ramps that controls to circulation of the building and site.

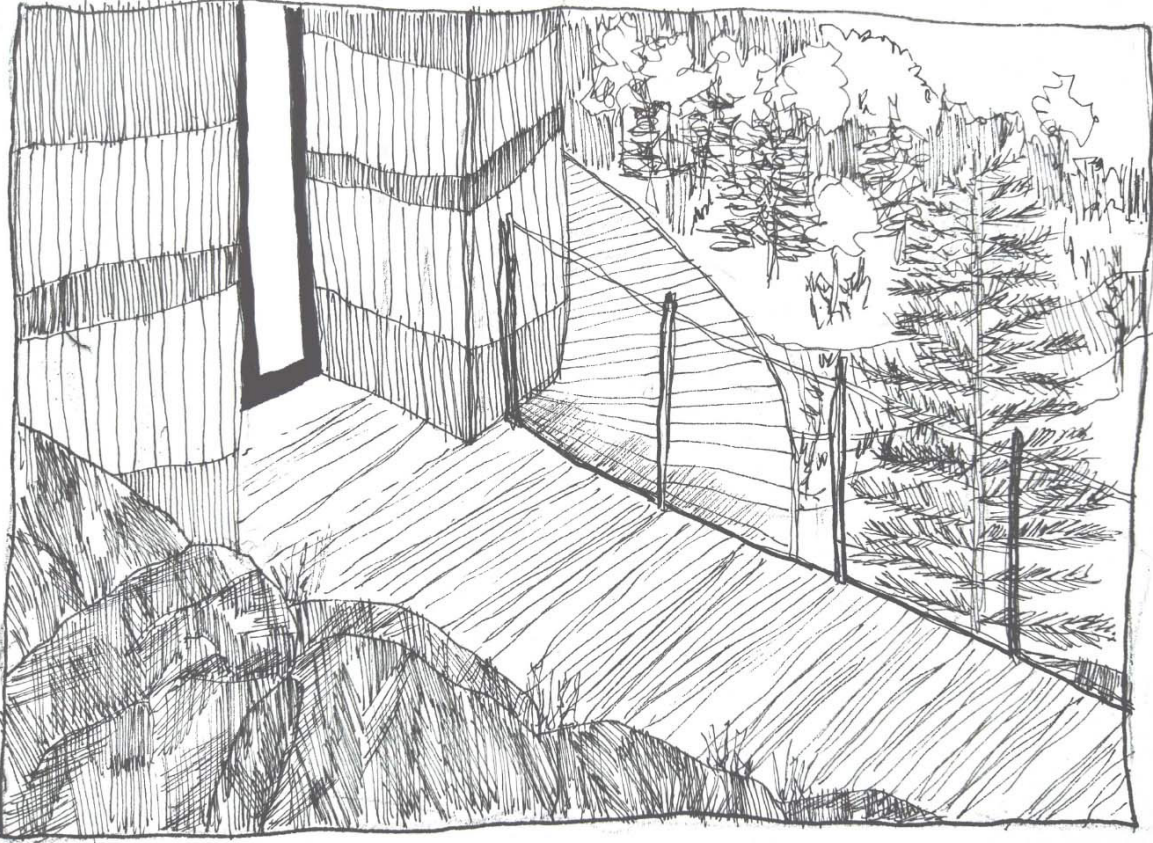
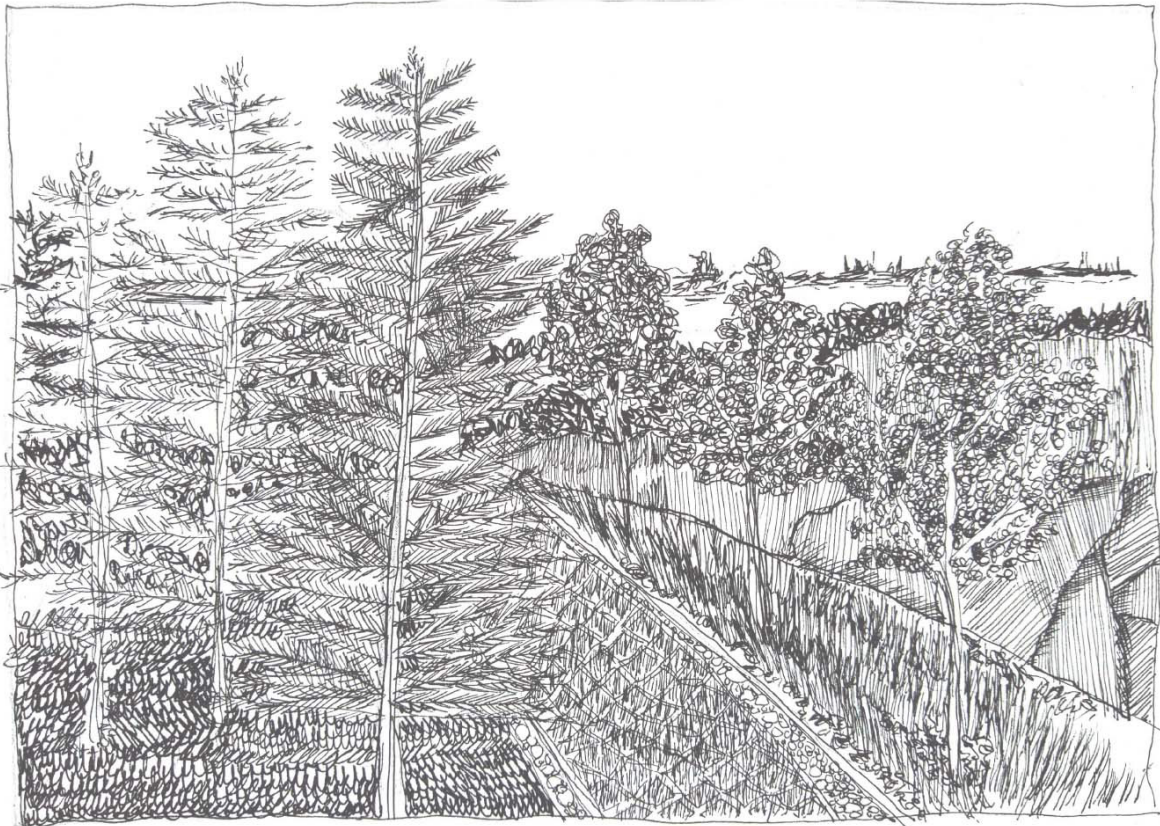

composed of 3 levels, vistor's are able to access the building from the top or bottom. as the parking is placed up the hill on the rock, a wheel-chair accessible ramp guides to user to the building, and beyond to the dock. bordered by a bioswale that extendeds from the parking lot, any erosion either from the foot-paths or cars will go through an extensive swale system that will eventually deposit its filtered water to the lake.

as visitors make their way down the ramp, a top view of the roof system allows for teaching opportunities of the transfer of water bodies and how they are cleansed, as the basin-like roofs drain water to an extension of the bioswale ontop of the outer ramp, later combining with the path swale.



site plan 1:200



elevation 1:50

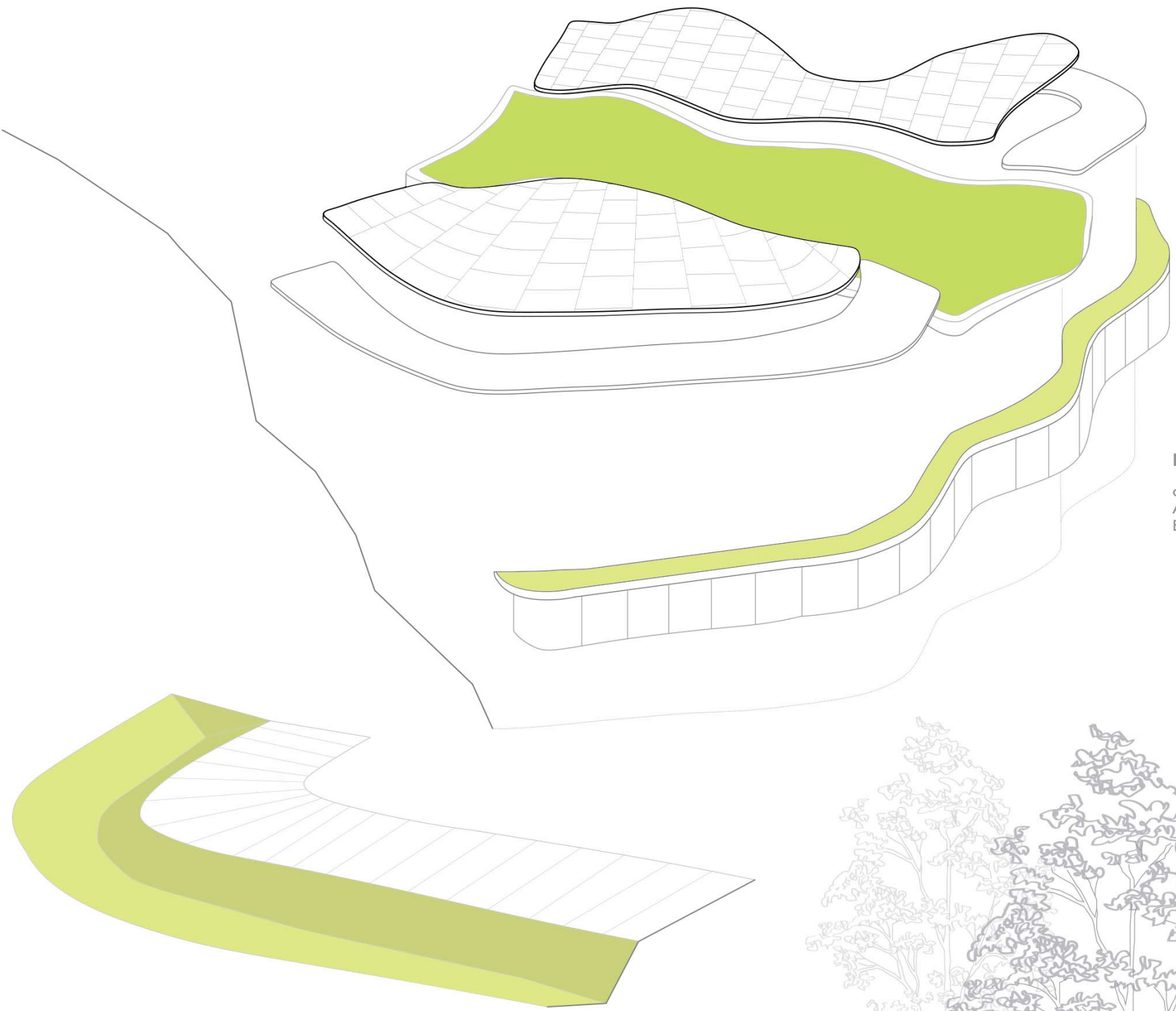

roof diagram

coursework from
Architecture and
Ecology class

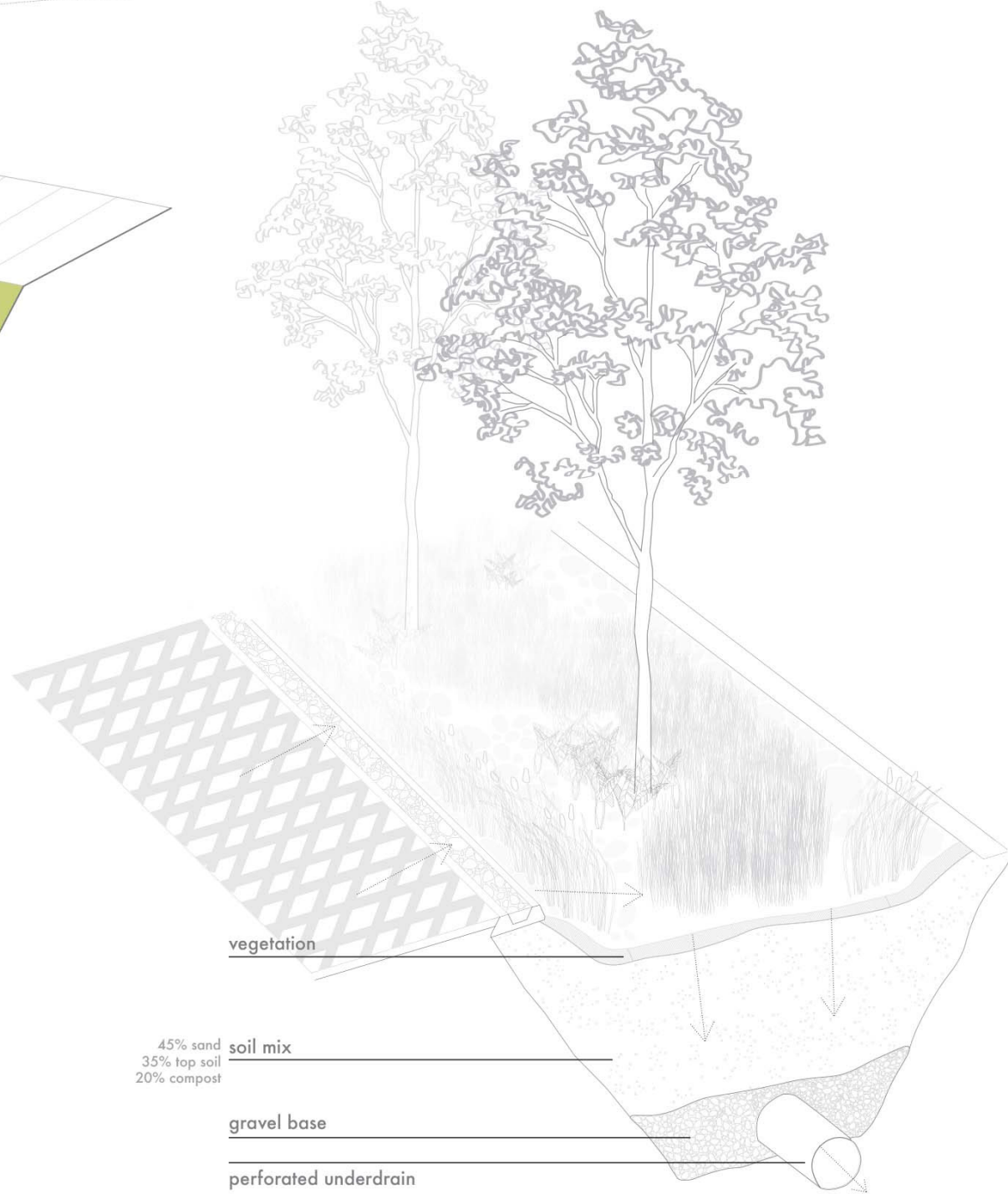

bioswale design

coursework from
Architecture and
Ecology class

legend

first floor

- 1 entrance/exhibit area
- 2 universal washrooms
- 3 lounge with fireplace
- 4 staff office

second floor

- 5 classroom
- 6 classroom/lab
- 7 classroom + storage + universal washroom

third floor

- 8 mudroom
- 9 lunchroom + classroom
- 10 kitchenette
- 11 outdoor storage

plans 1:50

1r: top to ground floor

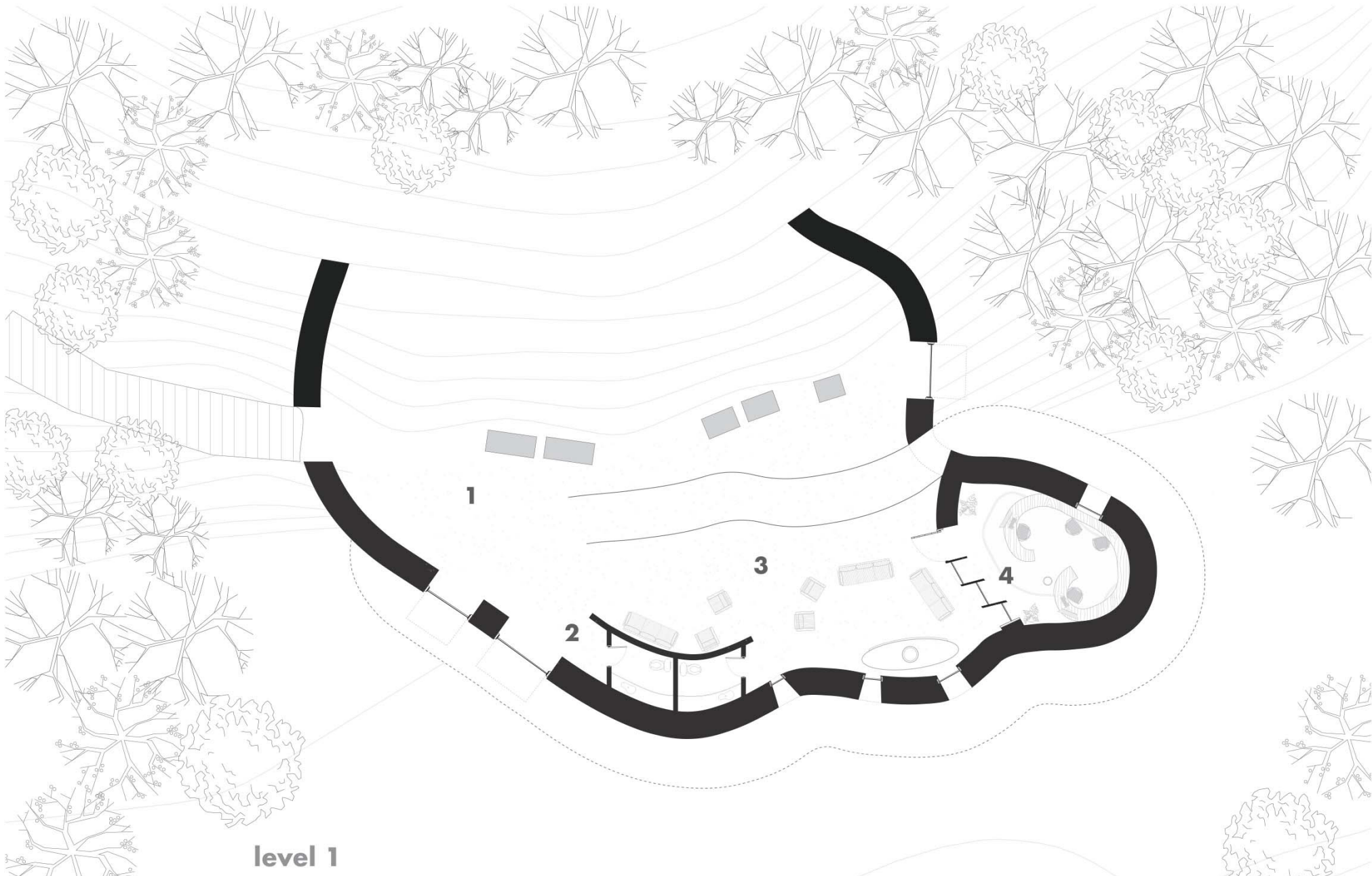

level 1



level 2

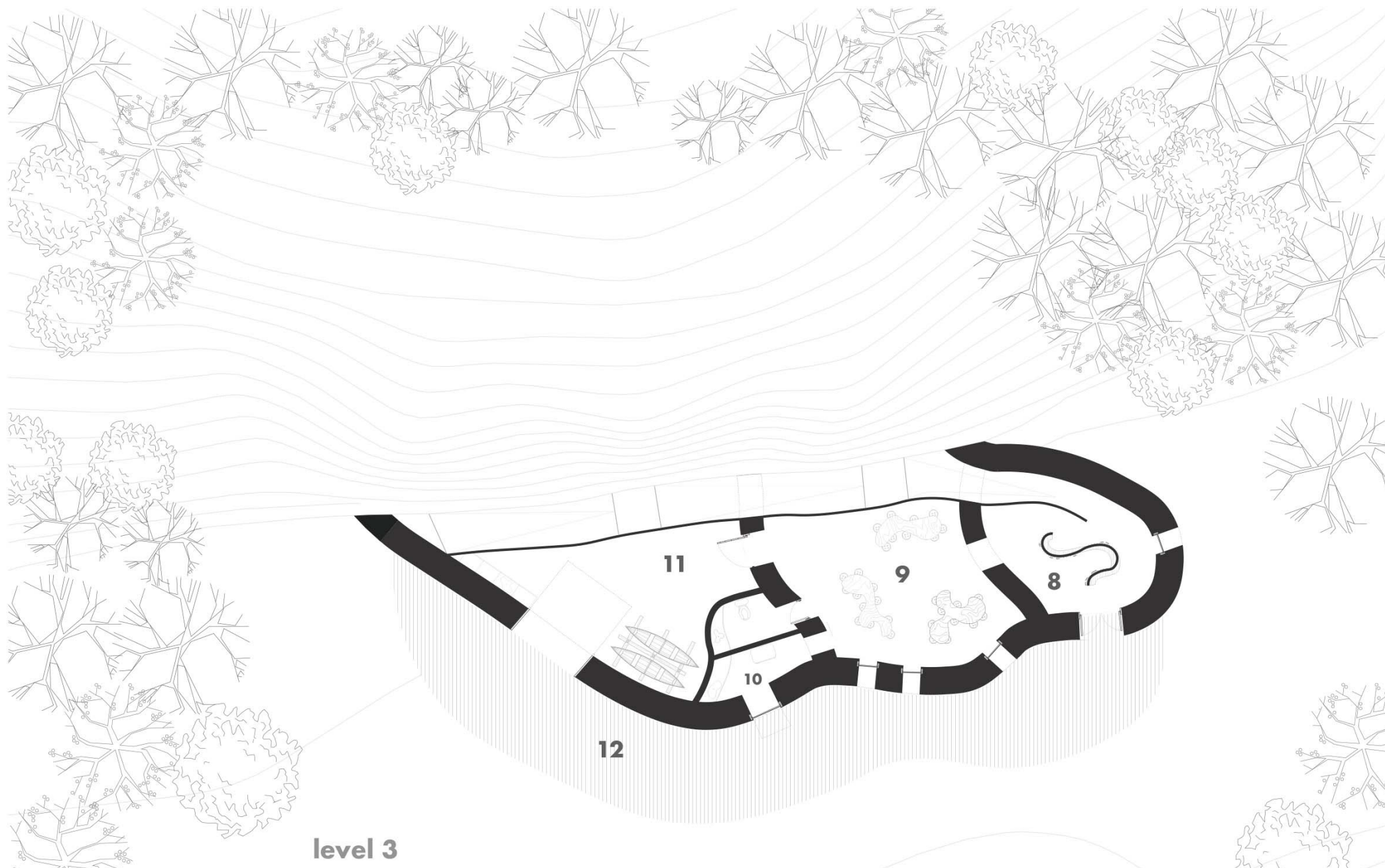

level 3

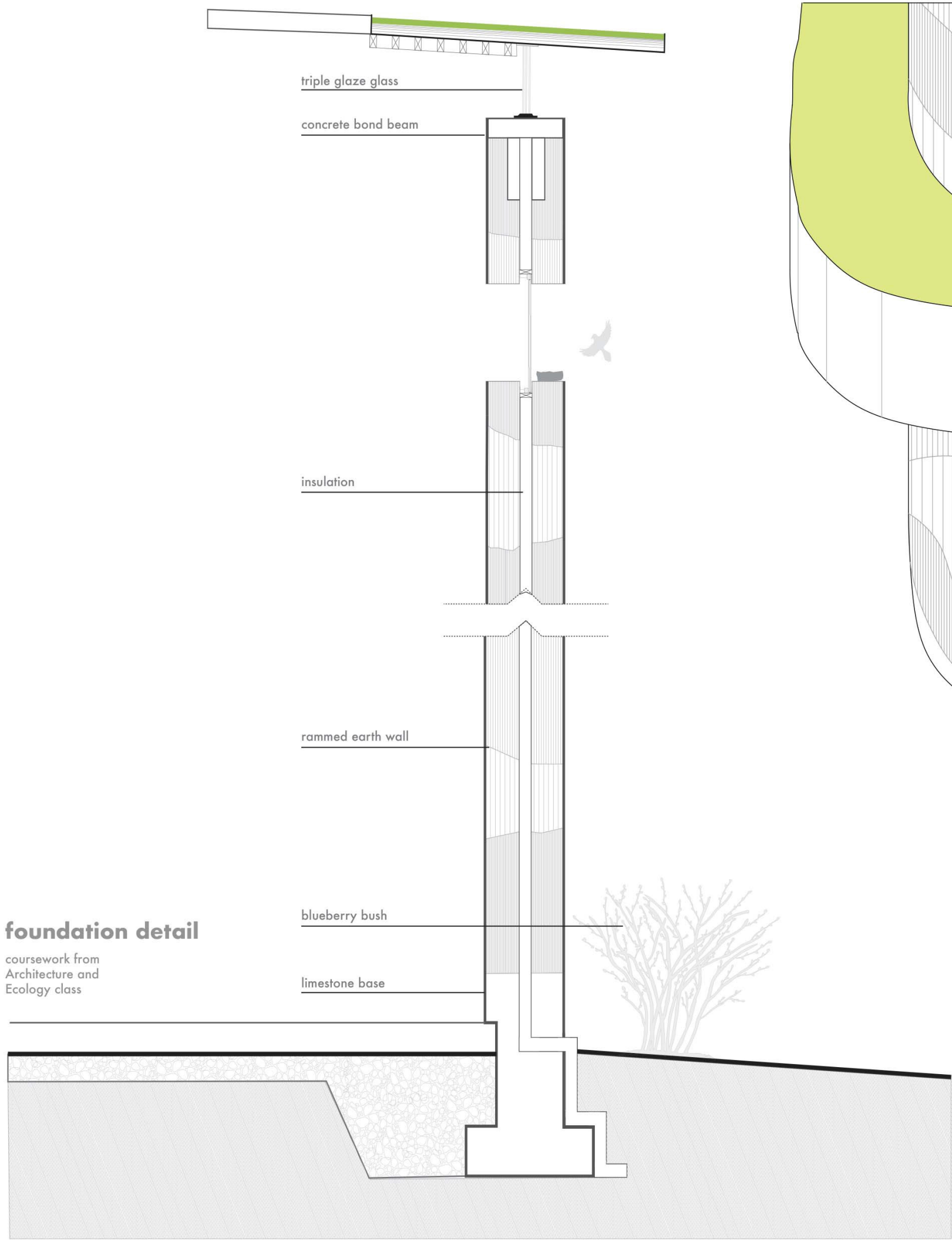

foundation detail

coursework from
Architecture and
Ecology class



providing natural light and views for visitors on the inside, and habitat for birds from the outside, windows strategically placed into the rammed earth are based on various birds' natural habitats, allowing to nest within the wall of the building, providing visitors from the inside to observe birds and the nesting cycle.

animal habitats

coursework from
Architecture and
Ecology class

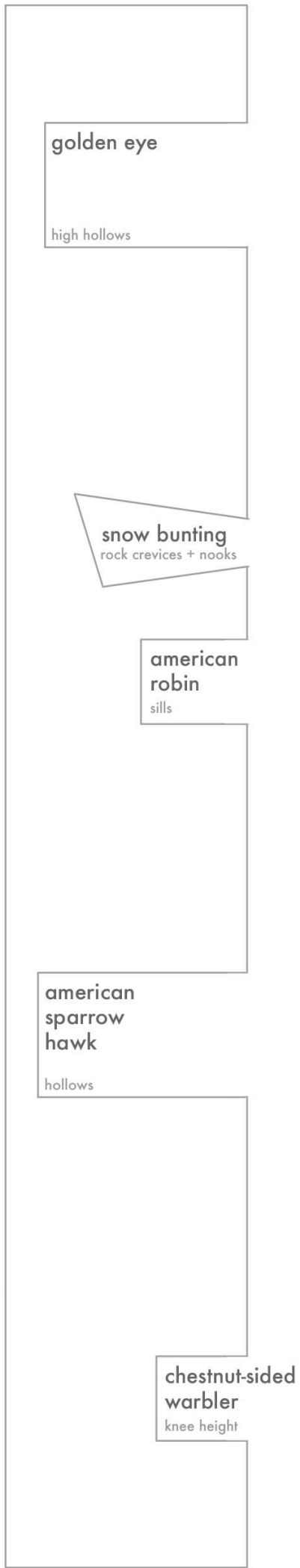

entrance to ramp

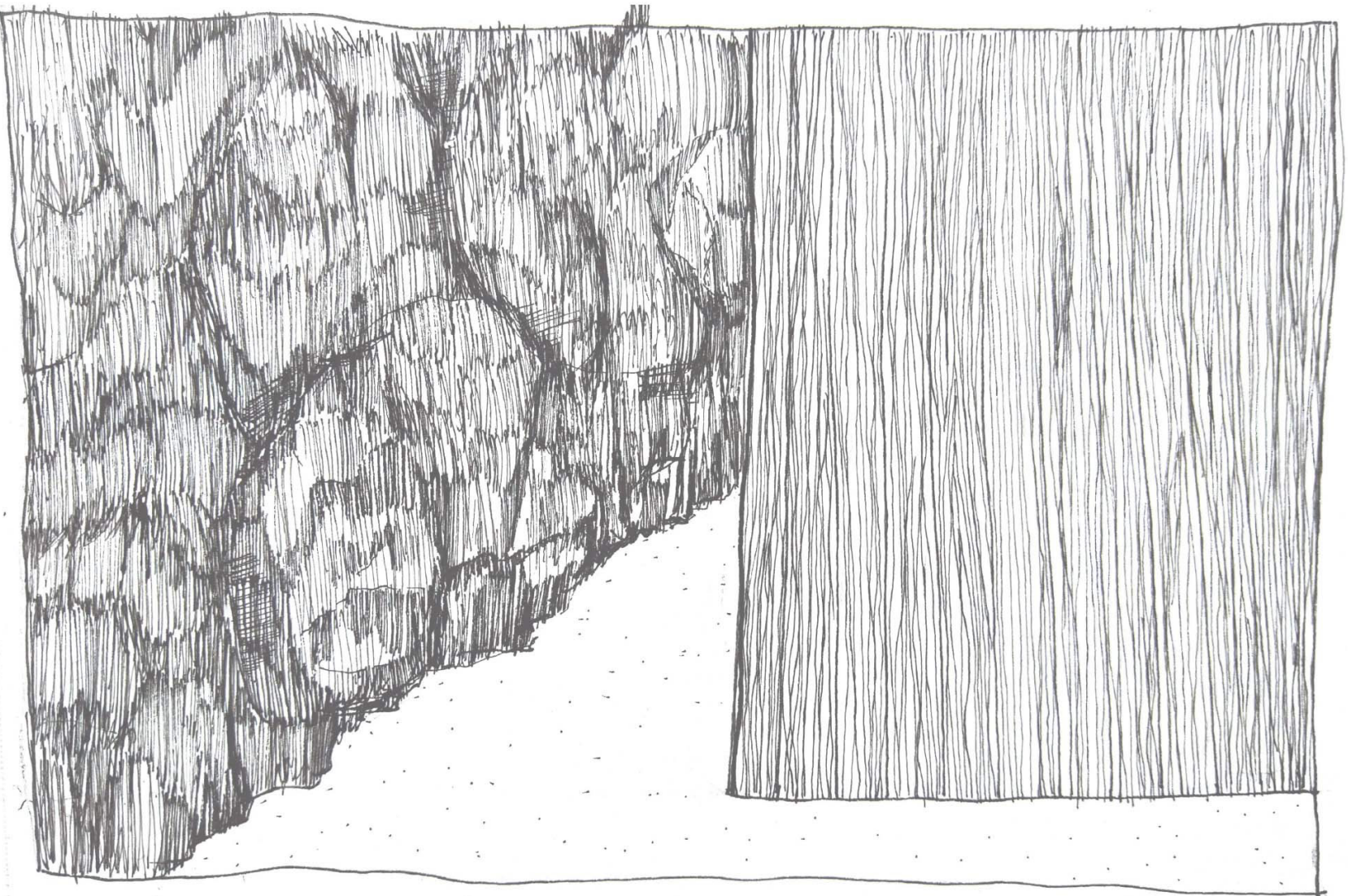

inside classroom

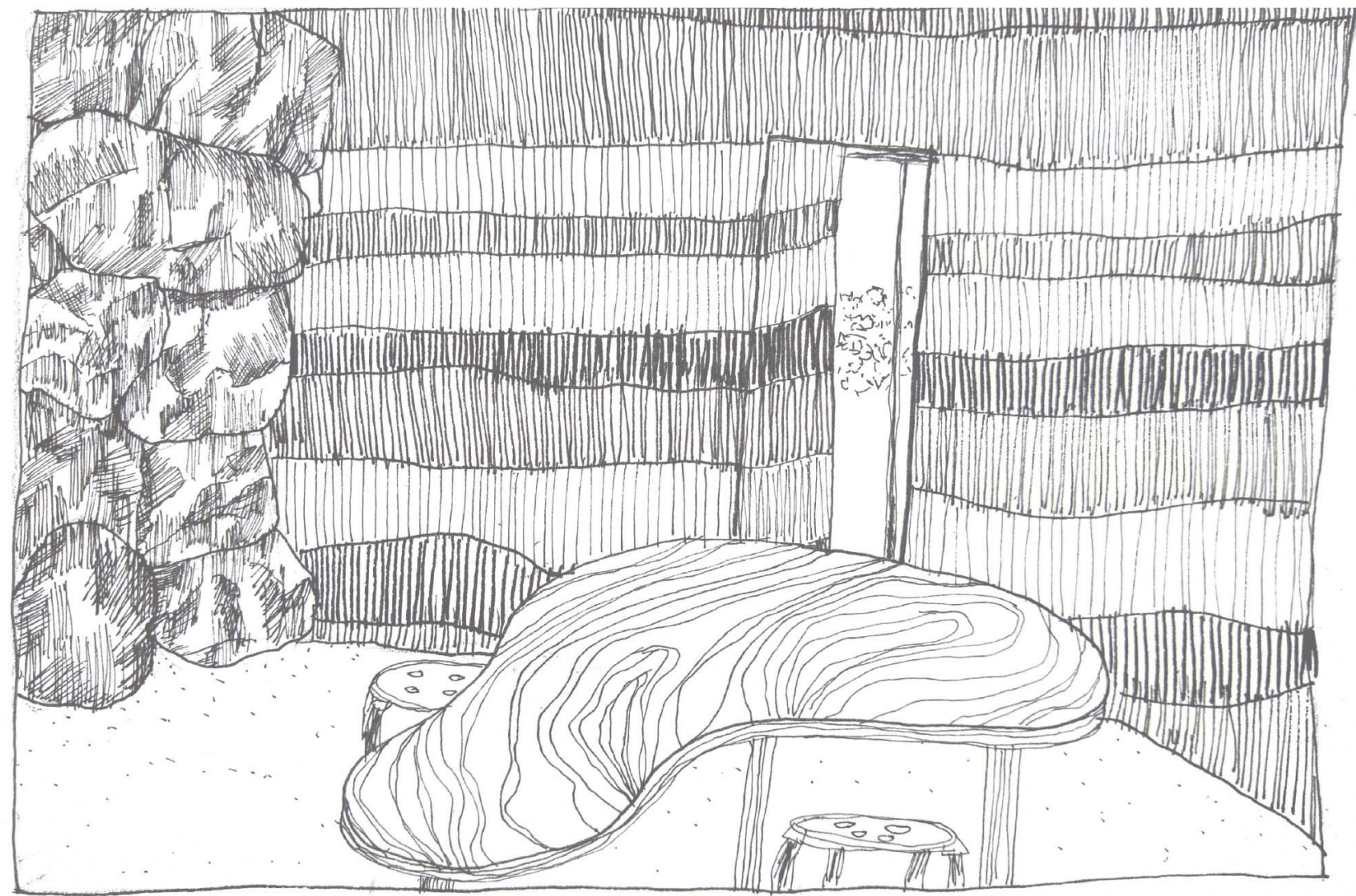

section 1:50

